

R16

Code No: 134BJ

JAWAHARLAL NEHRU TECHNOLOGICAL UNIVERSITY HYDERABAD

B.Tech II Year II Semester Examinations, December - 2019

MACHINE DRAWING

(Mechanical Engineering)

Time: 3 hours

Max. Marks: 75

Answer any THREE questions from Part-A

Part-B is Compulsory

PART - A

(30 Marks)

1. Draw two views of a single riveted butt joint with a double cover plate for a plate thickness of 18 mm. [10]
2. Draw the three views of a hexagonal headed bolt of nominal diameter 25 mm and length 100 mm; with a hexagonal nut and washer. [10]
3. Draw gib and cotter joint suitable for joining 40 mm square rods. [10]
4. Sketch the following types of keys in two views, as fitted in position between a shaft and the mounting. Choose the shaft diameter as 30 mm and the hub diameter of the mounting as 60 mm:
(a) Hollow saddle key (b) Taper sunk key
(c) Single headed feather key (d) woodruff key. [10]

PART - B

(45 Marks)

5. The details of an air cock are shown in figure. Assemble the parts and draw:
a) half sectional view from the front
b) view from the right and
c) the view from above. All the dimensions are in mm.

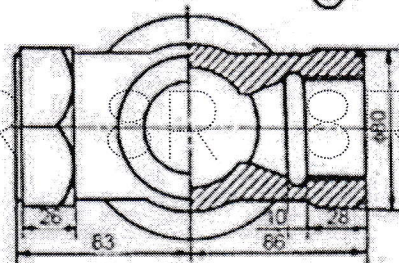
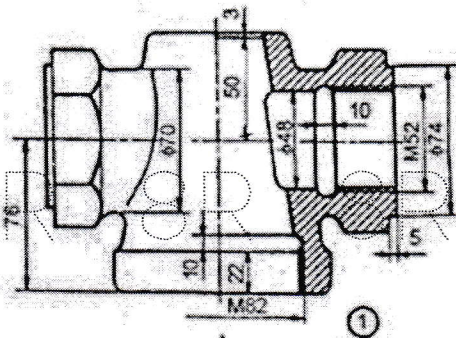
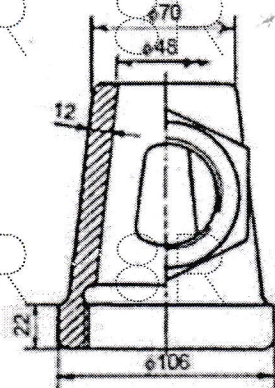
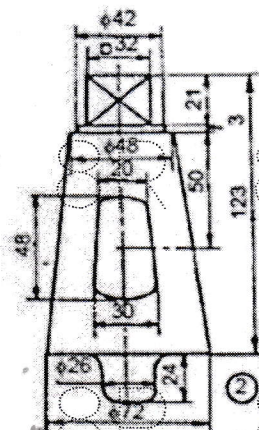
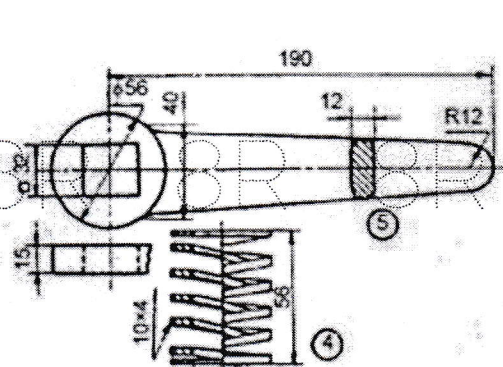

Parts list

Part No.	Name	Matl	Qty
1	Body	CI	1
2	Plug	CI	1
3	Screw cap	MS	1
4	Spring	Spring S	1
5	Lever	FS	1

